

ALL RIGHTS RESERVED. THESE DRAWINGS AND SPECIFICATIONS ARE THE PROPERTY AND COPYRIGHT OF WHITEWATER AND SHALL NOT BE REPRODUCED OR USED IN ANY OTHER WORK EXCEPT BY WRITTEN AGREEMENT WITH WHITEWATER.

SHUT DOWN LANES FOR WHIZZARD
MAT RACERS & FREE FALL SLIDE

MEZZANINE LEVEL DECK OVER
ACTION RIVER ON GROUND LEVEL

RENTAL CABANAS AT MEZZANINE LEVEL

PEDESTRIAN BRIDGE CONNECTION TO
CHILDREN'S RAIN FORTRESS PLAY STRUCTURE

ZIP COASTER UPHILL THRILL RIDE

BOOMERANGO INNER TUBE RIDE

WATER PARK POOL HALL
FOOT PRINT : 50,000 SF ±

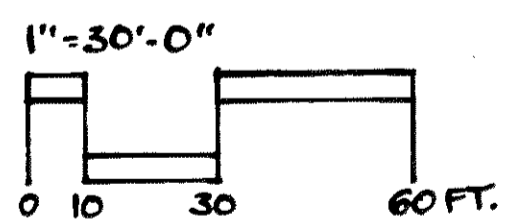

250 FT.

200 FT.

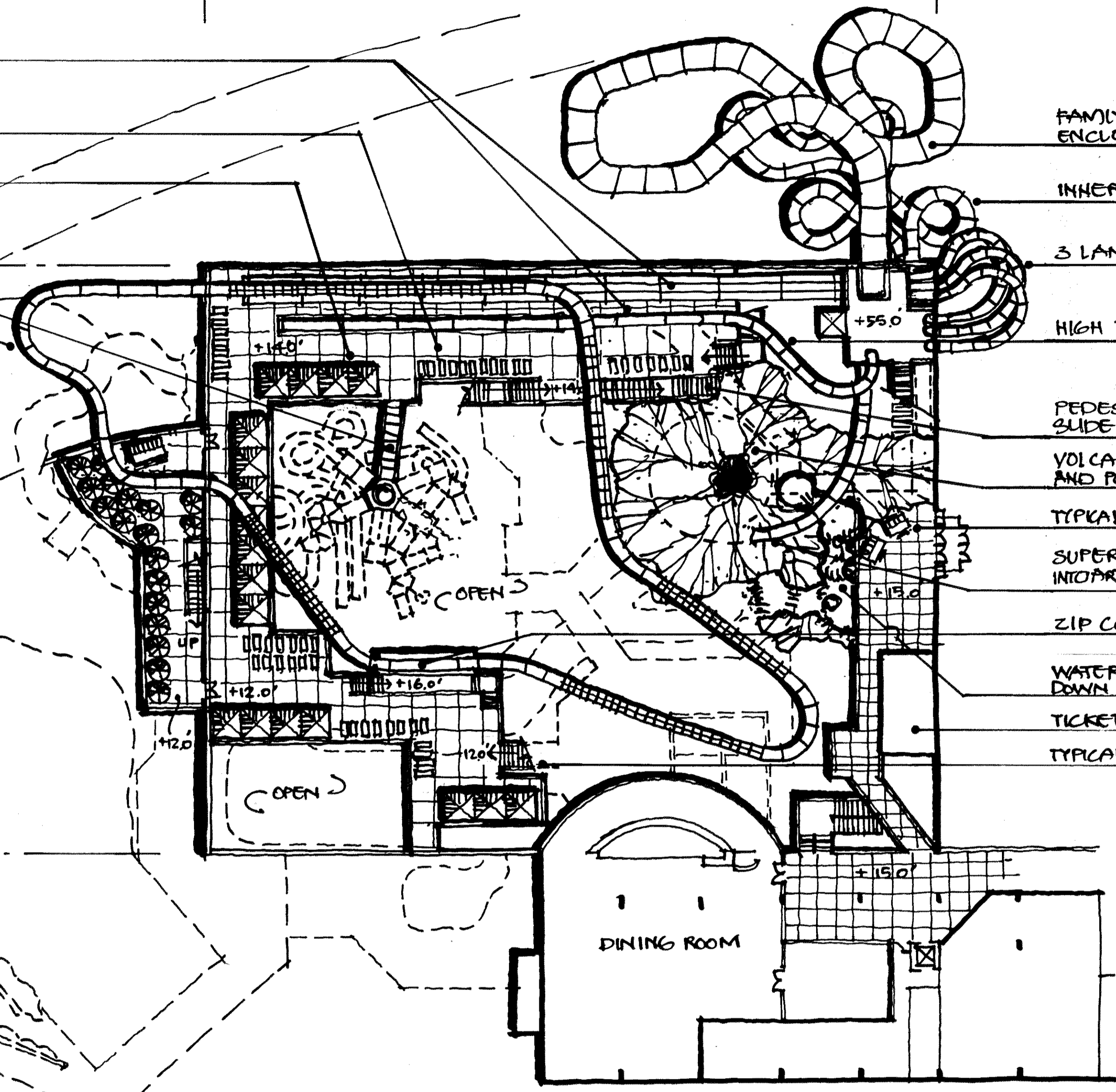

FAMILY RAFT RIDE 10' DIAMETER
ENCLOSED FLUME

INNER TUBE BLACK HOLE SLIDE

3 LANES WHIZZARD MAT RACERS

HIGH THRILLS FREE FALL BODY SLIDE

PEDESTRIAN ELEVATED WALKWAY TO
SLIDE TOWER, OVERLOOKING SUPERBOWL

VOLCANO ROCKWORK OVER SUPERBOWL
AND PORTION OF CHANGE ROOMS

TYPICAL RETAIL KIOSKS AT ENTRY

SUPERBOWL INNER TUBE FLUME ENTRY
INTO ARTIFICIAL VOLCANO FEATURE

ZIP COASTER STATION

WATER FALLS ON VOLCANO SPLASHING
DOWN INTO LAZY RIVER BELOW

TICKET SALES

TYPICAL STAIRS DOWN TO MAIN WATERPARK

UPPER LEVEL WATER PARK PLAN

VOLCANO ISLAND WATER PARK REVISED CONCEPT PLAN
FAIRMONT, WEST VIRGINIA, USA

REV			
DESIGNED BY:	DATE		
DRAWN BY: TW	DATE: SEPT. 28 / 06		
SCALE	1"=30'-0"		

NOTE:

WHITE WATER
Whitewater West Industries Ltd.
6700 McMillan Way, Richmond, BC Canada V6W 1J7
Tel: (604) 273-1088 Fax: (604) 273-4518

UPPER LEVEL
VOLCANO ISLAND WATER PARK
REVISED CONCEPT PLAN
FAIRMONT, WEST VIRGINIA, USA

PROJECT No. 14290	DRAWING No.	REVISION
----------------------	-------------	----------